

<b>PROJECT:</b>	<b>QTY:</b>	<b>ITEM No.</b>
-----------------	-------------	-----------------

# CTC9650R

## SELF-SERVE DISPLAY CASE (REMOTE)

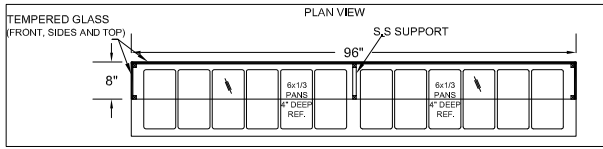

**NOTE(S):**

1. **DISPLAY CASE MUST NOT BE LOCATED IN DIRECT SUNLIGHT OR NEAR SOURCES OF AIR FLOW INCLUDING DOORS, WINDOWS AND VENTILATION SYSTEMS.**
2. **DIRECT DRAIN REQUIRED**
3. **FIXED THERMOPANE TEMPERED GLASS ON THE LEFT SIDE (FROM CUSTOMER VIEW) AND SOLID GABLES ON THE RIGHT (S.S EXTERIOR AND MIRROR FINISH INTERIOR)**

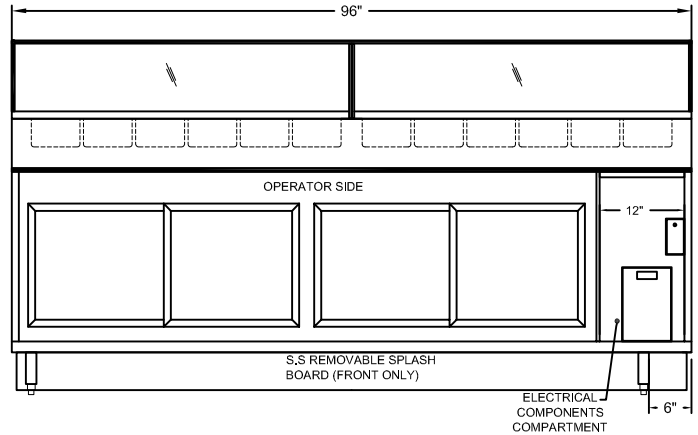
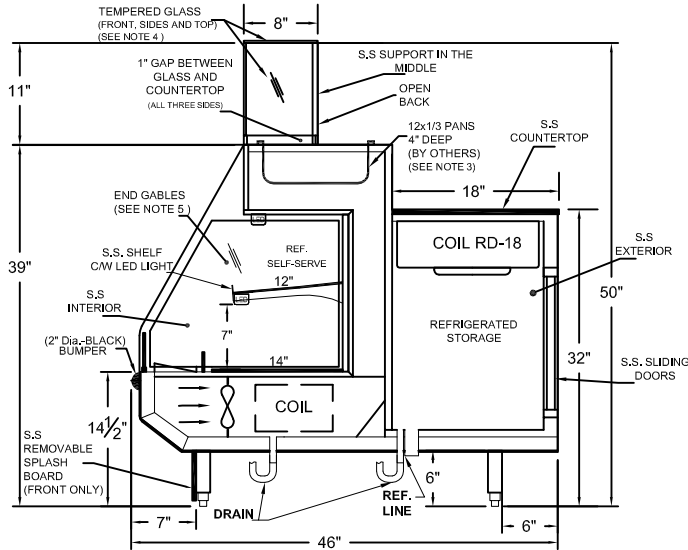

**REAR VIEW**

**SIDE VIEW**

**\* ALL DIMENSIONS ARE ± 1/8"**

\* PICTURE FOR REFERENCE ONLY



*Manufacturers of food service displays*

### SPECIFICATIONS

DIMENSIONS	CTC 9650R	MODEL No.	MODEL No.	MODEL No.	MODEL No.	MODEL No.
Length (in)	96"	L	L	L	L	L
Depth (in)	46"	D	D	D	D	D
Height (in)	50"	H	H	H	H	H
<b>ELECTRICAL</b>						
Voltage	120	120	120	120	120	120
Amperes <small>(Shelves and Lights)</small>	4.3	Amps.	Amps.	Amps.	Amps.	Amps.
Amperes <small>(Elect. Cond. Pan needs separate circuit)</small>	Amps.	Amps.	Amps.	Amps.	Amps.	Amps.
Power Cord	8 ft.	8 ft.	8 ft.	8 ft.	8 ft.	8 ft.

**NEMA Receptacle Configurations**

FOR LIGHTS

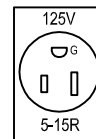

### NOTES

All Specifications subject to change without notice.  
 This Design is the property of QBD Modular Systems Inc. No copies or reproductions are permitted without the written permission of QBD Modular Systems Inc.  
 \*\* All units are designed to operate under normal store conditions of 24°C(75°F) with 50% relative humidity.  
 \*\*\*Condensation on glass may occur in Hot / Humid conditions. QBD is not responsible for any consequential damages as a result.  
 \*\*\*QBD WARRANTY DOES NOT INCLUDE PRODUCT LOSS OR CONSEQUENTIAL DAMAGES HOWEVER CAUSED. Please review detailed warranty statement prior to purchase.