

PROJECT:	QTY:	ITEM No.
-----------------	-------------	-----------------

CTC- CVIICXX59-RFS-SS-V

GRAB-N-GO COMBINATION DISPLAY CASE (VERTICAL)

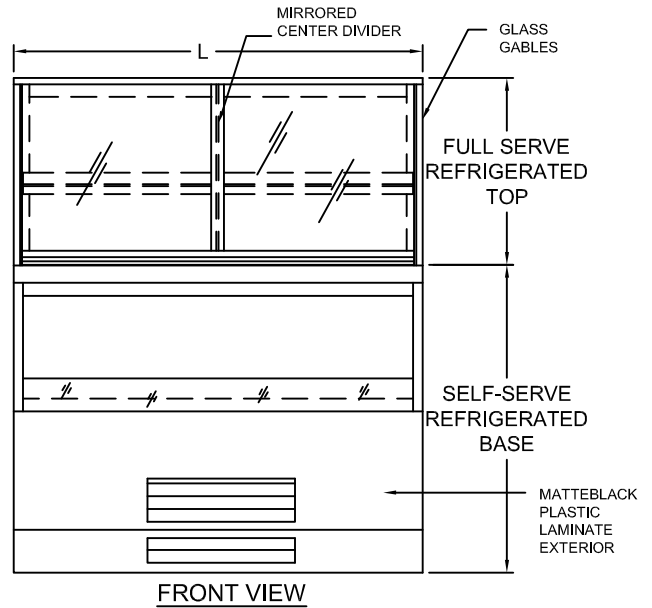
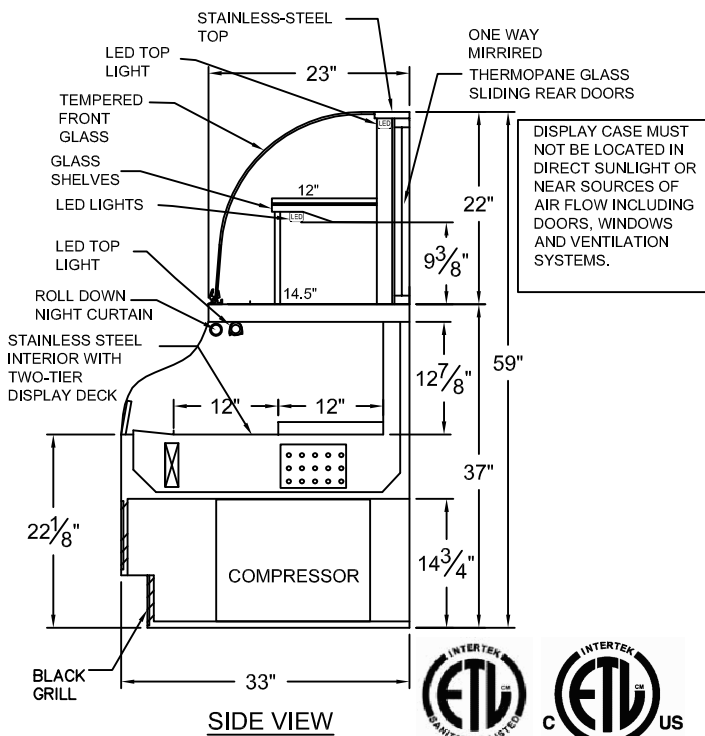

- * DIRECT DRAIN RECOMMENDED.
- * TOP SECTION CAN BE CONVERTED TO AMBIENT OR REFRIGERATED.
- * TWO SOURCES OF POWER REQUIRED FOR
 - 120V-20Amp. CIRCUIT REQUIRED FOR COMPRESSOR & LIGHTS.
 - 120V-15Amp. CIRCUIT REQUIRED FOR ELECTRIC COND. PAN.

* PICTURE FOR REFERENCE ONLY



Manufacturers of food service displays

SPECIFICATIONS

DIMENSIONS	CVIIC 3659RV	CVIIC 4859RV	CVIIC 6059RV	CVIIC 7159RV		
Length (in)	36"	48"	60"	71"		
Depth (in)	33"	33"	33"	33"		
Height (in)	59"	59"	59"	59"		
ELECTRICAL						
Voltage	120	120	208	120	208	120
Amperes <small>(Compressor and Light)</small>	10.5	12.5	8.5	-	10.3	-
Amperes <small>(Elect. Cond. Pan needs separate circuit)</small>	8.3	8.3	-	8.3	-	8.3
Power Cord	8 ft.	8 ft.	8 ft.	8 ft.	8 ft.	8 ft.

NEMA Receptacle Configurations

FOR COMPRESSOR & LIGHTS

FOR L = 36"

FOR L = 60", 71"

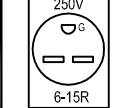
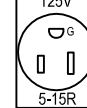

FOR L = 48"

For Elec. Cond. Pan

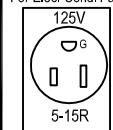
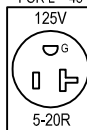

NOTES

All Specifications subject to change without notice.
This Design is the property of QBD Modular Systems Inc. No copies or reproductions are permitted without the written permission of QBD Modular Systems Inc.

** All units are designed to operate under normal store conditions of 24°C(75°F) with 50% relative humidity, and maintain the temp. between 35°F to 40°F.

**Condensation on glass may occur in Hot / Humid conditions. QBD is not responsible for any consequential damages as a result.

**QBD WARRANTY DOES NOT INCLUDE PRODUCT LOSS OR CONSEQUENTIAL DAMAGES HOWEVER CAUSED. Please review detailed warranty statement prior to purchase.



QBD MODULAR SYSTEMS INC. TEL: (905) 459-0709

31 BRAMSTEELE ROAD, BRAMPTON, ONTARIO, CANADA L6W 3K6

WWW.QBD.COM

1-800-663-3005

FAX: (905) 459-1478

info@qbd.com

DR. BY: **Hesam**

DATE: **06/ 01/ 15**

FILE: **CTC-CVIICXX59-RFS-SS-V**